

# Radial Lead RF Chokes

## Special Features

- High current capacity
- Ferrite bobbin core
- Low core loss at frequency
- High reliability, efficiency
- Fixed lead spacing
- Operating temperature -30 to +100 °C

## Notes

\* Current to cause max. 10 % of inductance drop, or 40 °C temperature rise

† RoHS Directive 2002/95/EC Jan 27 2003 including Annex.

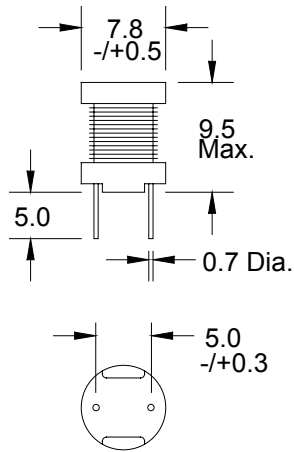

Dimensions: mm

RL895 Series				
Part Number	L (μH) ±20 %	Test Freq.	DCR (Ω) Max.	I, DC* (mA)
RL895-100M-RC	10	2.52 MHz	0.04	2600
RL895-120M-RC	12	2.52 MHz	0.04	2600
	±10 %			
RL895-150K-RC	15	2.52 MHz	0.05	2100
RL895-180K-RC	18	2.52 MHz	0.05	2000
RL895-220K-RC	22	2.52 MHz	0.06	1700
RL895-270K-RC	27	2.52 MHz	0.06	1600
RL895-330K-RC	33	2.52 MHz	0.07	1400
RL895-390K-RC	39	2.52 MHz	0.08	1400
RL895-470K-RC	47	2.52 MHz	0.10	1300
RL895-560K-RC	56	2.52 MHz	0.11	1200
RL895-680K-RC	68	2.52 MHz	0.14	1100
RL895-820K-RC	82	2.52 MHz	0.16	1000
RL895-101K-RC	100	1 KHz	0.19	900
RL895-121K-RC	120	1 KHz	0.22	820
RL895-151K-RC	150	1 KHz	0.27	740
RL895-181K-RC	180	1 KHz	0.31	710
RL895-221K-RC	220	1 KHz	0.38	640
RL895-271K-RC	270	1 KHz	0.53	570
RL895-331K-RC	330	1 KHz	0.61	510
RL895-391K-RC	390	1 KHz	0.69	480
RL895-471K-RC	470	1 KHz	0.89	430
RL895-561K-RC	560	1 KHz	1.01	400
RL895-681K-RC	680	1 KHz	1.18	350
RL895-821K-RC	820	1 KHz	1.57	320
RL895-102K-RC	1000	1 KHz	1.84	300
RL895-122K-RC	1200	1 KHz	2.10	270
RL895-152K-RC	1500	1 KHz	2.80	230
RL895-182K-RC	1800	1 KHz	3.21	210
RL895-222K-RC	2200	1 KHz	4.21	190
RL895-272K-RC	2700	1 KHz	4.94	170
RL895-332K-RC	3300	1 KHz	6.16	150
RL895-392K-RC	3900	1 KHz	6.84	140
RL895-472K-RC	4700	1 KHz	7.89	130
RL895-562K-RC	5600	1 KHz	11.5	120
RL895-682K-RC	6800	1 KHz	13.2	110
RL895-822K-RC	8200	1 KHz	15.3	100
RL895-103K-RC	10,000	1 KHz	22.0	89
RL895-123K-RC	12,000	1 KHz	25.0	73
RL895-153K-RC	15,000	1 KHz	29.1	68
RL895-183K-RC	18,000	1 KHz	38.9	66
RL895-223K-RC	22,000	1 KHz	44.9	59
RL895-273K-RC	27,000	1 KHz	55.2	52
RL895-333K-RC	33,000	1 KHz	64.2	48
RL895-393K-RC	39,000	1 KHz	74.2	42
RL895-473K-RC	47,000	1 KHz	96.4	38

“-RC” suffix indicates RoHS compliance.